

Courses & Distances
on the Creek

- N. 51. W. 8
- N. 80. W. 60
- S. 40. W. 69
- N. 45. W. 28
- N. 10. W. 91
- N. 31. W. 51

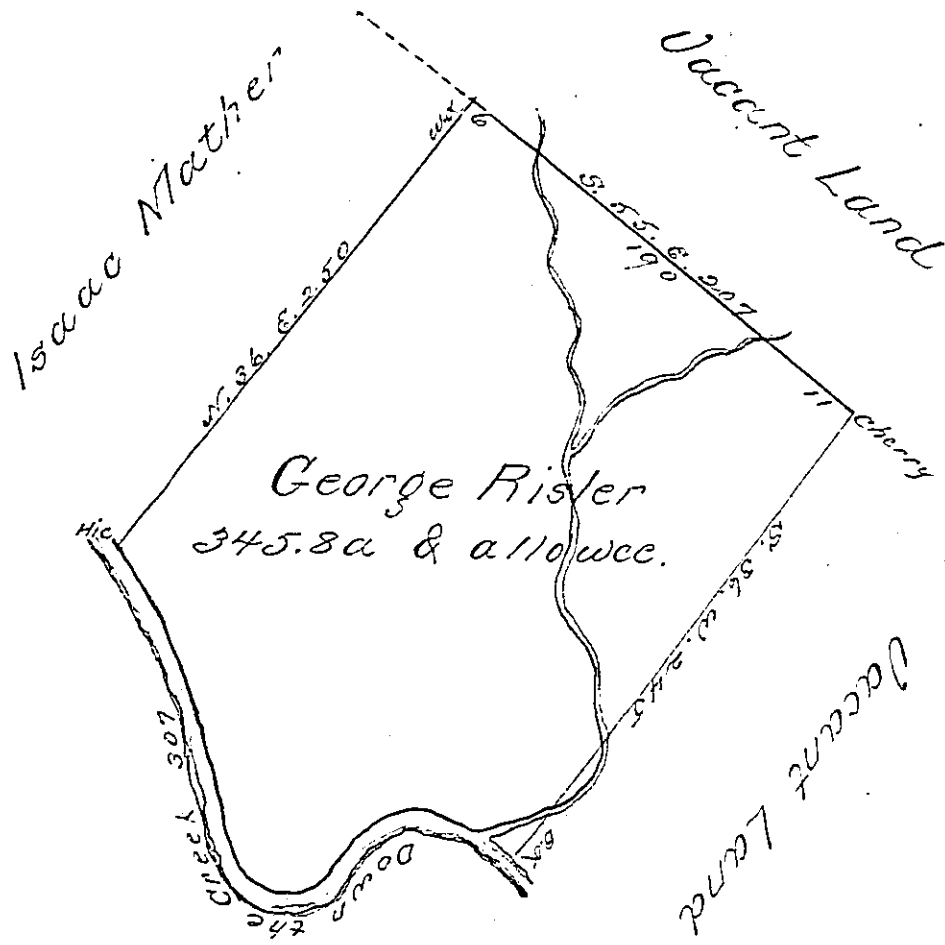

Survey'd to George Risler on the 23d Day of
September 1776 The above described Tract of three hun-
dred forty five acres & three Quarters & an acre & allow-
ance of Six p.ct. Situate on the North Side of Crooked
Creek adjoining Land granted to Isaac Mather in
Westmoreland County By Warrant of the 20th Day
of August 1776

p. Joshua Elder S. Genl.

To John Lukens Esqr. S. Genl.

IN TESTIMONY that the above is a copy of the original remaining on file in
the Department of Internal Affairs of Pennsylvania, made
conformably to an Act of Assembly approved the 16th day of
February, 1833, I have hereunto set my Hand and caused
the Seal of said Department to be affixed at Harrisburg,
this fourth day of September 1900

James W. Latta
Secretary of Internal Affairs.